



CLEANING BEER FAUCETS

DISASSEMBLING, CLEANING & REASSEMBLY INSTRUCTIONS

BY: ZACH GEORGE, OWNER OF BARRELS AND BOTTLES BREWING IN GOLDEN, COLORADO

EXAMPLE: *PERLICK FLOW-CONTROL FAUCET*

CLEANING YOUR FAUCETS SHOULD BE AS IMPORTANT AS CLEANING YOUR LINES

DISASSEMBLE YOUR BEER FAUCET

1. Using your faucet wrench, carefully take off your faucet and soak it in a warm cleaning solution for 15-20 minutes to loosen parts.
1. Unscrew and remove (H).
2. Unscrew and remove (G).
3. Turn (K) to the open position to remove (J).
4. Unscrew (L) and remove the flow control assembly.
5. Use your *Faucet Tool Kit* carefully to remove (D) .
6. Remove (M) from the (A) faucet.
7. Pull (E) upward and out. You may have to push back on (E) to remove it.
8. Use your *Faucet Tool Kit* carefully at the end of (A) faucet to remove (C).
9. Use your *Faucet Tool Kit* carefully to remove (B2) from top of (A) faucet.
10. Remove the remaining seals: (B1) , (F) and check (L) seals and ALL seals for worn marks or cracks

- Soak **ALL** parts/seals in a non-caustic or caustic solution (depending on beer stone build-up) for at least 30 mins.
- Next, soak **ALL** parts/seals in a High Foaming Sanitizer (no-rinse is preferable) for at least 30 mins.
- This should be done every 2 weeks

REASSEMBLE YOUR BEER FAUCET

1. Use your finger(s) and/or Faucet Tool Kit to re-install (B2) into it's groove.
2. Use your finger(s) and/or Faucet Tool Kit to re-install (C) into it's groove.
3. Insert (E) back in (A) faucet.
4. Re-install (F) and (B1).
5. Tighten (G) by hand only and do not over tighten.
6. Screw (H) back on (E)
7. Insert (M) first and then (J).
8. Replace or re-install (D).

CHEMICALS

- Non - Caustic Acid Cleaner
- Caustic Acid Cleaner
- High Foaming Sanitizer
- Acids are recommended to descale the lines & faucets of beerstone & biofilms

FAUCET DIAGRAM

TOOLS NEEDED

5 GALLON BUCKET / SINK
PPE

FAUCET WRENCH

FAUCET TOOL KIT (PREFERABLY BRASS)



- A- FAUCET
- B1 / B2- O-RING
- C- O-RING
- D- COUPLING GASKET
- E- HANDLE LEVER
- F- BEARING CUP
- G- COMPRESSION BONNET
- H- HANDLE JACKET
- J- FLOW CONTROL LEVER ASSEMBLY
- K- LEVER FOR FLOW CONTROL LEVER ASSEMBLY
- L- NUT FOR FLOW CONTROL LEVER ASSEMBLY
- M- COMPENSATOR

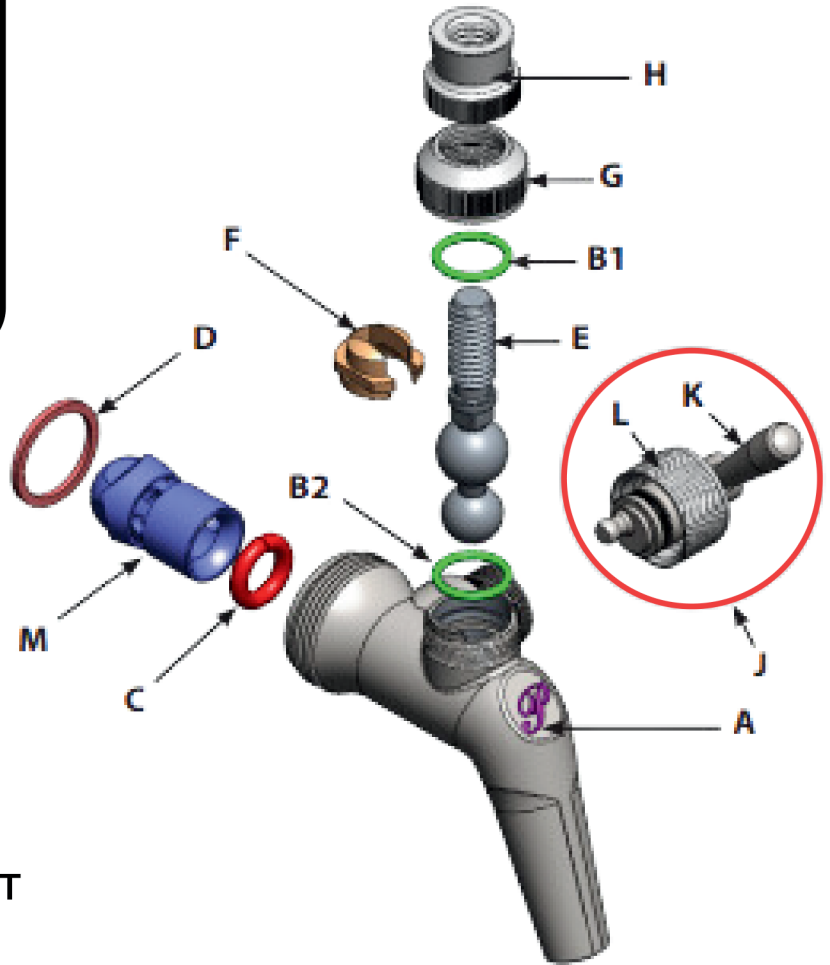

REFERENCES:

<https://foxxequipment.com/faucet-wrench-standard-20b03125>

<https://fhsteinbart.com/product/lever-o-ring-perlick-545pc-13/>

<https://foxxequipment.com/o-ring-tool-kit-2-pc-3-4-ends-parker-20s04100>

<https://www.micromatic.com/en-us/keg-tapping-tools-faucets-shanks/g-TCAyNX-58kuzUXzTyYP3nA>